

# ClearLock 660

## Technical datasheet

Rev. 05 • Update 09/2024

**AUTOMATIC**  
SYSTEMS

**ClearLock™**

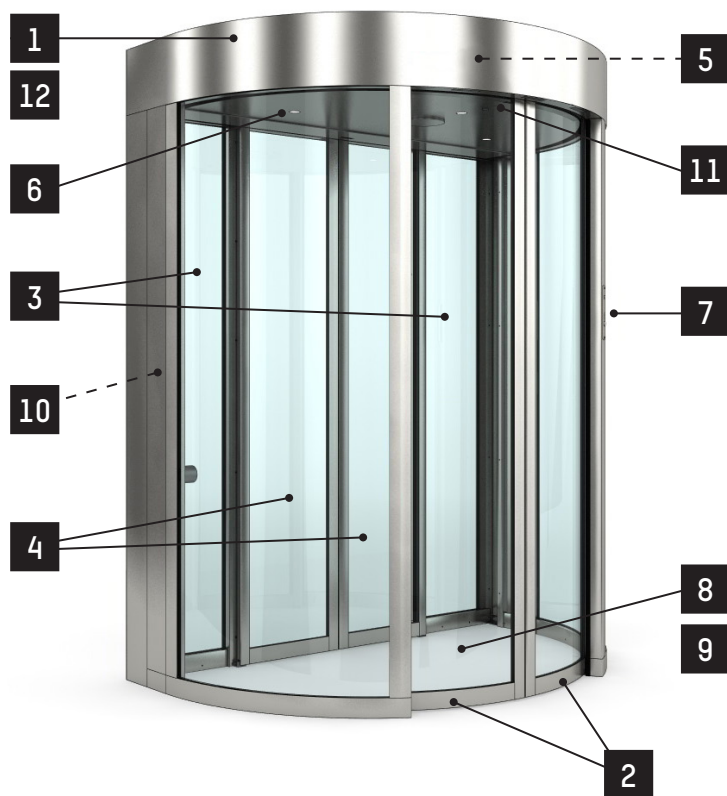

The **ClearLock** automatic semi-circular security booths are designed to provide high security access control and management of pedestrian flow.

Their design and robust manufacture allow easy integration into prestigious site such as office buildings, airports, laboratories and sensitive sites.

The feature that sets this high-security **ClearLock 660** booth apart is its semicircular shape with a flat sliding door on the exterior and a curved sliding door on the interior. These are motorised and bi-directional.

The high-security **ClearLock 660** booth is equipped with two mobile obstacles which provide a **free passage area of 900 mm and a height of 2.150 mm**. Connected to an automatic sliding door, its offers a solution for private access (existing facades, special passage height).

### DESCRIPTION

1. Painted steel **upper casing** containing the drive mechanism and the control board unit of the security booth.
2. **Curved mobile obstacles** in laminated clear glass BR2S P6B. Each door panel is equipped with a protection ensuring the safety of users.
3. **Lateral panels** made of painted steel and laminated clear glass BR2S P6B.
4. **Double-leaf flat sliding door** made of painted steel and laminated clear glass BR2S P6B.
5. **Control board unit & motorisation** comprising:
  - Programmable electronic board
  - I/O interface board for access control system
  - Remote console for operating mode adjustment
  - Voice messages device
  - Two back-up batteries ensuring 100 cycles in case of power failure
  - Electro-mechanical lock of the obstacles (with programmable unlocking in case of power failure)
  - Safety cells for reopening in case a presence is detected in front of the obstacles (anti-pinch safety)
6. **Spotlights** for the passageway lighting.
7. **Status light:** red and green LED displays indicating the status of the security booth.
8. **Bubble rubber base floor.**
9. **«Single person» detection by floor weight detection system** (2 directions).
10. **Push buttons** for emergency opening and intercom.
11. **Lock** for external door locking.
12. **Interior roof removable (by screw)** retained by a safety chain, for maintenance.



[www.automatic-systems.com](http://www.automatic-systems.com)

## STANDARD TECHNICAL CHARACTERISTICS

Power supply	220V +/- 10%, 50Hz
Consumption	400 W
Battery backup	2 batteries 7Ah for emergency function in case of power breakdown.
Motors	1 internal motor 40Vdc - 40W for reversible movement of the wings 1 external motor 24Vdc - 250W.
Safety	Sensors placed on the door frame both in entrance and exit. Control system that guarantees the regulation of the motor torque.
Passages	- 6 passages per minute in entrance or exit. - 6/8 passages per minute in both directions (such data do not consider the possible working times due to utilization of card/badge readers)
Dimensions	Overall dimensions (mm): Height: 2400 Width: 1910 Length: 1250 Passage dimensions (mm): Height: 2150 Width: 900
Weight	1050 kg depending on glass
Relative ambient humidity	90%, without condensation
Ambient operating temperature	-10° to +55°C
MCBF (Mean cycles between failures)	<b>1,000,000</b> cycles, in compliance with recommended maintenance
MTTR (Mean time to repair)	1 hour
<b>CE</b>	Complies with European standards

## CONFIGURATIONS

1. RAL7035 Light Grey (by default) - RAL9011 Black - RAL9010 White - RAL8019 dark brown.
2. Semi-circular position:
  - entry / unsecured zone (by default).
  - exit / secured zone.
3. In case of power failure :
  - By default: The exit door (secured side) remains locked.  
The entry door (unsecured side) opens automatically.
  - All doors remain locked.
4. Integration of card reader, intercom and/or push button at the entry and/or exit of the booth.
5. Choice of the language of voice message and control consol.

## SURFACE TREATMENT

All the mechanical parts are treated against corrosion by electro zinc, according to RoHS norms.

## WORKS TO BE PROVIDED BY THE CUSTOMER

- Fixing on the floor.
- Power supply.
- Connection between booth and access control devise.

**Note:** Follow the installation plan.

## OPTIONS

### SPECIFIC OPTIONS

- IP33 rain protection compatible with weight detection system. <sup>1, 2</sup>
- Metal detector & left object control (entry way only). <sup>3</sup>
- Mechanical emergency opening system of both external and internal doors.
- Heating of the canopy for outside front installation in extra cool climates (-30°C up to +50°C).
- Dismountable booth (instead of welded). Shipment in parts.
- White opaque glass.

### GENERAL OPTIONS

- Break-in detection on the cover plate of the roof (microswitch contact).
- Medium structured satin paint in : other RAL colours than RAL7035, RAL9011, RAL8019, RAL9010.
- Flush mat powder coating in : any RAL colour.
- Brushed AISI 304 stainless steel finishing - big doors.
- Profile for wall connection (per side : entry, exit or middle position).
- Frame for floor built-in installation (25mm).
- Support on the post inside the booth for reader installation inside the booth.
- Support for readers (width > 85mm) fixed on the external (entrance) side or fixed on the internal (exit) side of the booth metal structure.
- Integration of any non-standard intercom or emergency button into the product (specific information of the device and desired position to be provided for customization).
- Mechanical locker for metal objects with 10 drawers.
- Radar for automatic door opening (entry or exit way).
- Colour video micro-camera inside of the booth (to be connected to a screen not supplied)
- Auxiliary control console (in connection with the standard control console).
- Delivery without any control console.
- Converter RS485 to LAN for booth networking
- Service kit (Iuppiter software + several cables). <sup>4</sup>
- Top canopy with a different height, to close the space between the booth top and the ceiling (up to 500mm).
- Virtual Console for remote monitoring (software installed on a Linux server - server integrated or server touch).
- Virtual Console for remote monitoring (software installed on a PC Panel PSE 3215 21,5" - B8 module : CPU Celeron Apollo Lake J3455).

<sup>1</sup> The IP33 protection includes on the unsecured side of the booth : tight weight detection, tight user command plate + half-roof canopy.

<sup>2</sup> The IP33 protection includes on the unsecured side of the booth is highly recommended when the semi-circular booth is positioned next to the outside building facade. It is of no use in the opposite configuration CF/HSP/026.

<sup>3</sup> This metal detection option is not compatible with the RC4 glass doors option.

<sup>4</sup> This kit is to be ordered once per installation site.

**Note:** For restrictions on options, please contact us.

### STANDARD DIMENSIONS (MM)

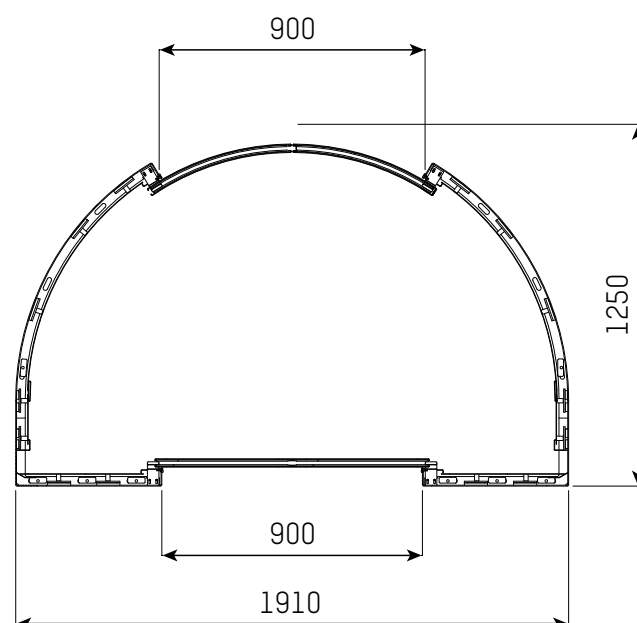
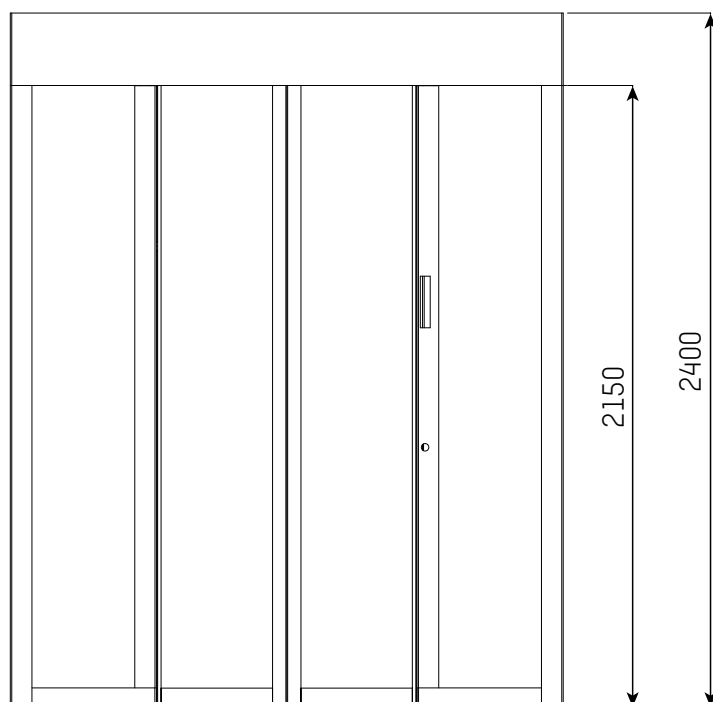

#### Headquarters

Avenue Mercator, 5  
1300 Wavre - Belgium

sales.asgroup@automatic-systems.com

+32.(0)10.23.02.11

www.automatic-systems.com



CL 660-FT-EN-05